

Roon

Roon

가

. Control, Output, Core

Roon

Roon Ready

Roon Ready Roon Server, Roon Remote

. Roon Ready

RoonBridge

. hqplayer_naa

Roon Ready config

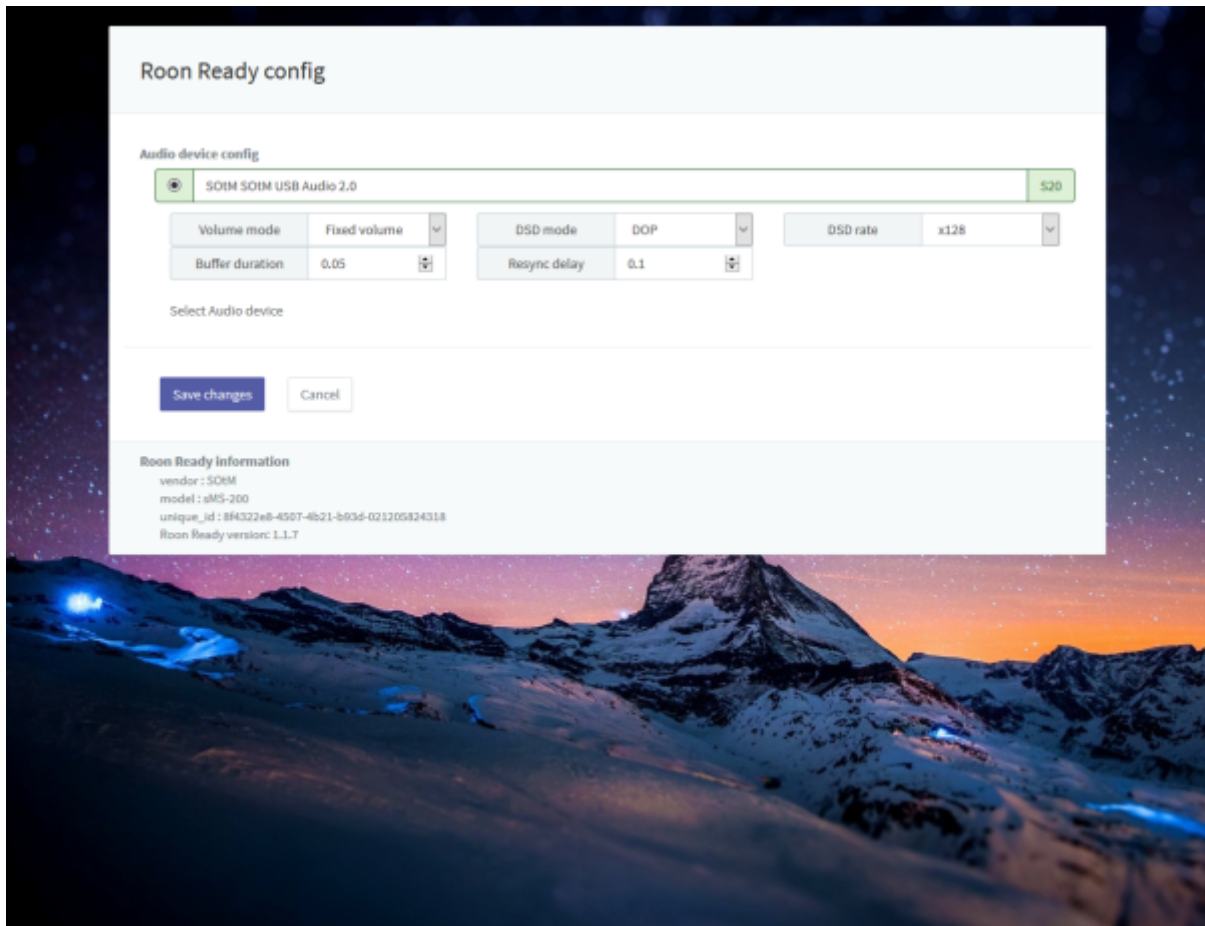

- **Audio device config:** USB DAC
- **Volume mode:** Fixed, Software, Device Controls
- **DSD mode:** DSD NONE, NATIVE, DOP, DCS, NATIVE/DOP, NATIVE/DCS
- **DSD rate:** DSD x64, x128, x256
- **Buffer duration:** 0.01 ~ 0.1

- Resync delay: 0.1 ~ 0.5 가 0.01

Roon Ready

Remote Roon Server Roon Ready 'Active' Roon
Settings > Audio Roon Ready SMS-200

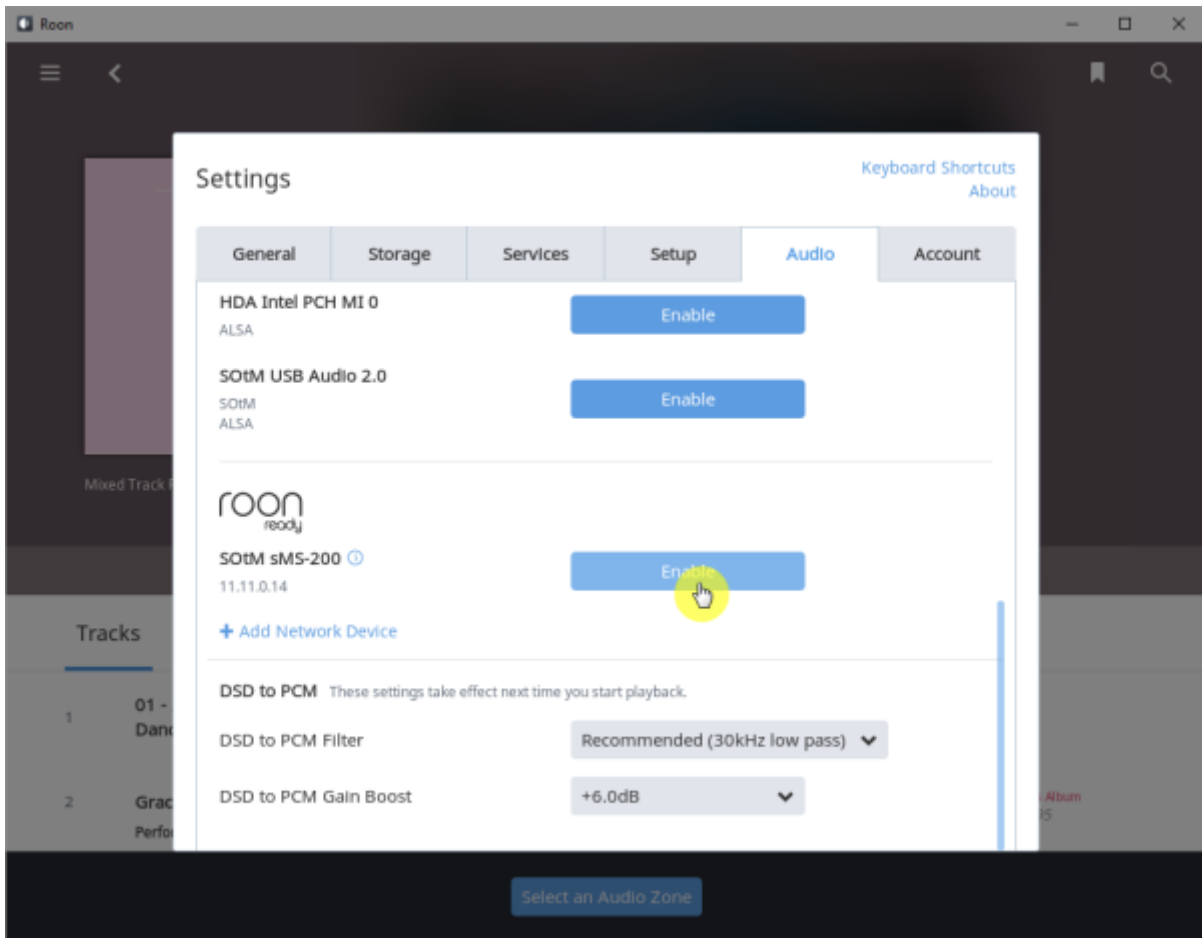

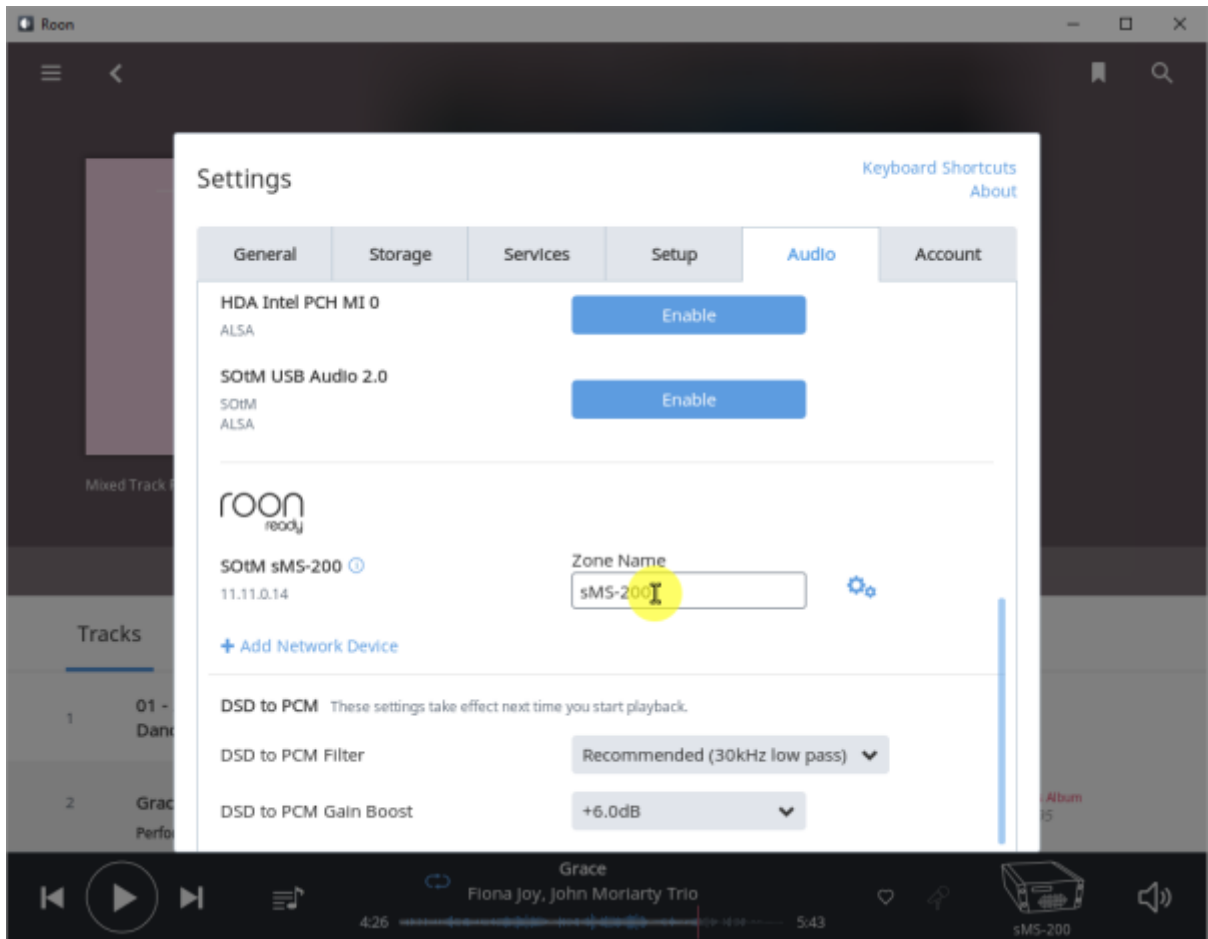

sMS-200 Audio zone

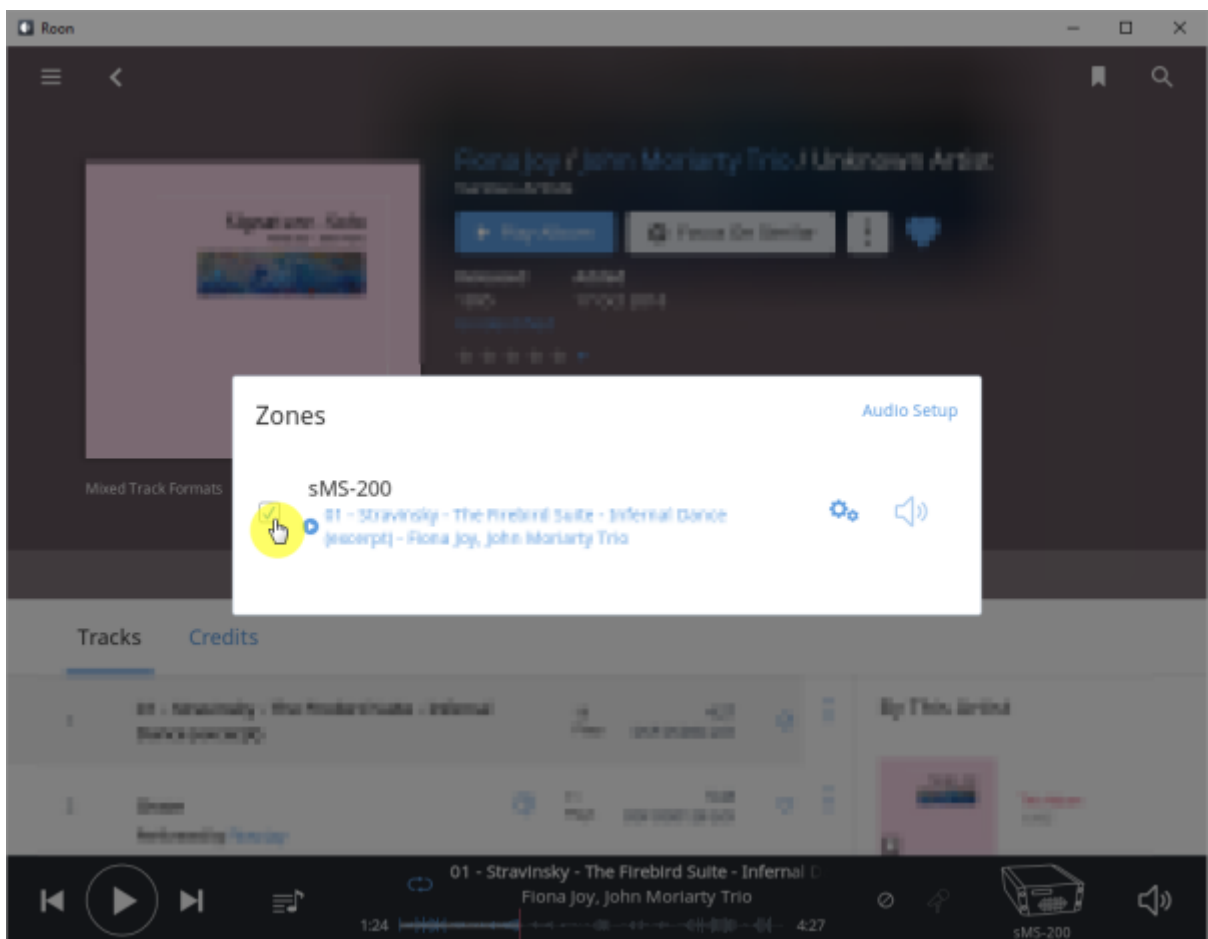



Roon Server

Roon Server Roon Core Roon Output Roon Remote [Roonlabs](#)

Roon core 1.3 'sample rate conversion' SMS-1000SQ
 DSD . Max PCM rate 384 khz

Roon Server

[Eunhasu](#) Roon Server 'Active'

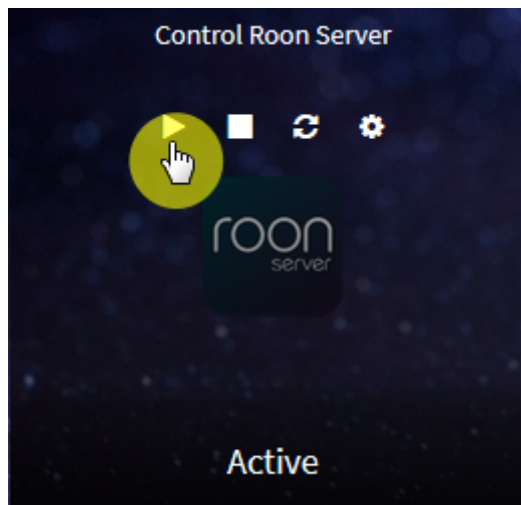

[Roon Server](#) 가 'Active' Roon remote Roon Core SMS-1000SQ



Core



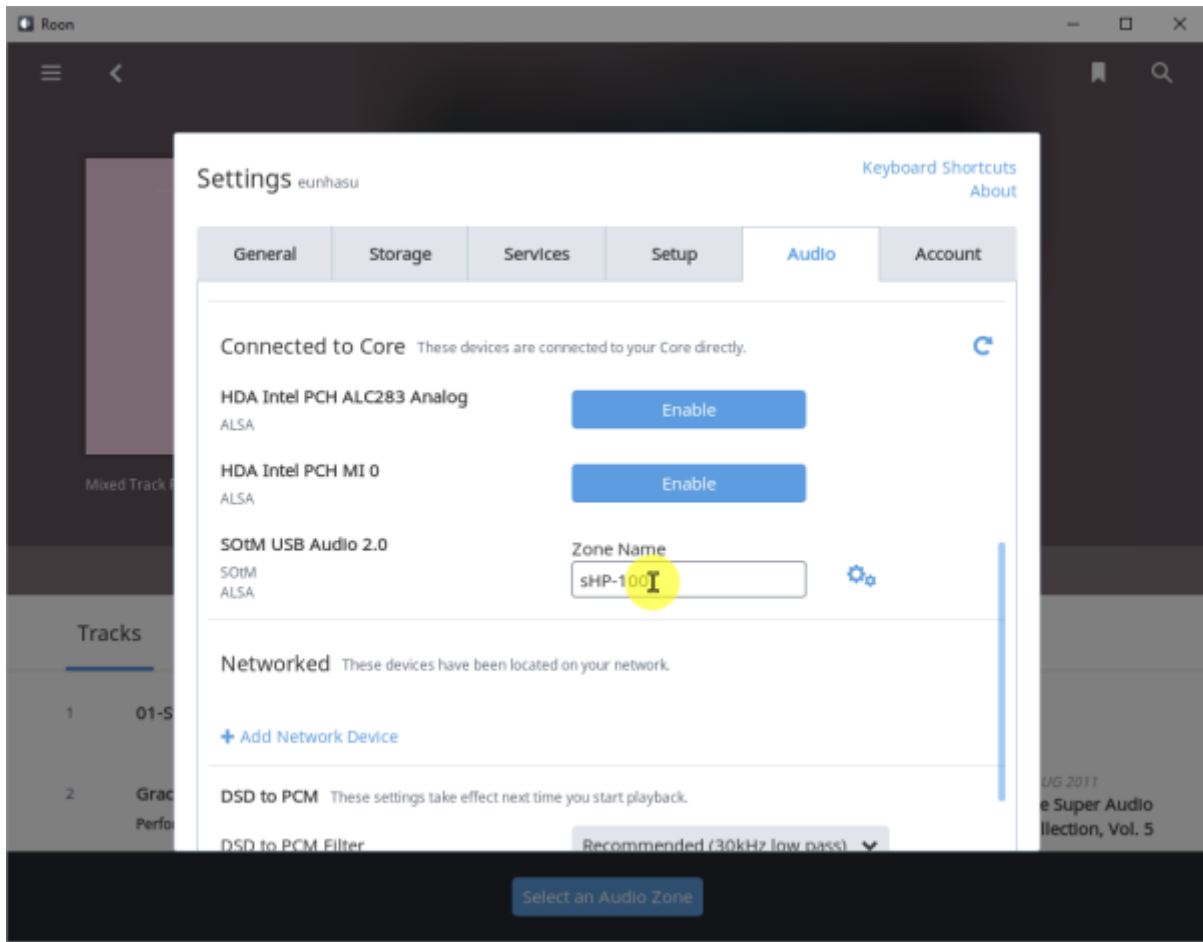

Audio Zone



: 2017/03/07 02:32

From:
<https://docs.sotm-audio.com/> - **SOTM docs**

Permanent link:
<https://docs.sotm-audio.com/doku.php?id=ko:roon&rev=1488871965>

Last update: **2017/03/07 02:32**

